

8" Portable DVD Player
PDM-0082M



User's Manual



20060425

Important Safety Instructions

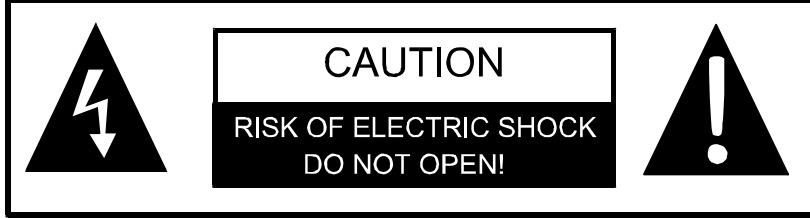

CAUTION: TO REDUCE THE RISK OF ELECTRIC SHOCK, DO NOT REMOVE COVER (OR BACK). NO USE-SERVICEABLE PARTS INSIDE. REFER SERVICING TO QUALIFIED SERVICE PERSONNEL.



The lightning flash with arrowhead symbol, within an equilateral triangle, is intended to alert the user to the presence of uninsulated "dangerous voltage" within the product's enclosure that may be of sufficient magnitude to constitute a risk of electric to persons.



The exclamation point within an equilateral triangle is intended to alert the user to the presence of important operating and maintenance (servicing) instructions in the literature accompanying the appliance.

WARNING: TO REDUCE THE RISK OF FIRE OR ELECTRIC SHOCK, DO NOT EXPOSE THIS APPLIANCE TO RAIN OF MOISTURE.



CAUTION: Laser radiation when open. Do not stare into beam.

CAUTION: USE OF ANY CONTROLS, ADJUSTMENTS, OR PROCEDURES OTHER THAN THOSE SPECIFIED HEREIN MAY RESULT IN HAZARDOUS RADIATION EXPOSURE.

POWER SUPPLY:

Connect the supplied adapter to the side of the DVD player in the slot marked "Power In". Plug the two-prong end of the power cord to an AC100-240V outlet. If you have difficulty inserting the plug, turn it over and reinsert it; if the unit will not be used for a long time, disconnect the plug from the outlet.

NOTE:

Before plugging the power cord into an AC outlet, make sure that all the connections have been made.

Important Safety Instructions

CAUTION: These servicing instructions are for use by qualified service personnel only. To reduce the risk of electric shock, do not perform any servicing other than that contained in the operating instructions unless you are qualified to do so. Refer to service manual for servicing instructions.

- 1) Read these instructions.
- 2) Keep these instructions.
- 3) Heed all warnings.
- 4) Follow all instructions.
- 5) Do not use near water.
- 6) Clean only with dry cloth.
- 7) Do not block any ventilation openings. Maintain well ventilated conditions around the product. Do not put product on bed, sofa or anything that blocks ventilation. Install in accordance with the manufacturer's instructions.
- 8) Do not install near any heat sources such as radiators, heat registers, stoves, or other apparatus (including amplifiers) that produce heat.
- 9) Do not defeat the safety purpose of the polarized or grounding-type plug. A polarized plug has two blades with one wider than the other. A grounding type plug has two blades and a third grounding prong. The wide blade or the third prong is provided for your safety. If the provided plug does not fit into your outlet, consult an electrician for replacement of the obsolete outlet.
- 10) Protect the power cord from being walked on or pinched particularly at plugs, convenience receptacles, and the point where they exit from the apparatus.
- 11) Only use attachments/accessories specified by the manufacturer.
- 12) Use only with the cart, stand, tripod, bracket, or table specified by the manufacturer, or sold with the apparatus. When a cart is used, use caution when moving the cart/apparatus combination to avoid injury from tip-over. 
- 13) Unplug this apparatus during lightning storms or when unused for long periods of time.
- 14) Refer all servicing to qualified service personnel. Servicing is required when the apparatus has been damaged in any way, such as power-supply cord or plug is damaged, liquid has been spilled or objects have fallen into the apparatus, the apparatus has been exposed to rain or moisture, does not operate normally, or has been dropped.
- 15) Apparatus shall not be exposed to dripping or splashing and no objects filled with liquids, such as vases, shall be placed on the apparatus.

Note: Do not touch the color TFT LCD screen by hand directly.

Important Safety Instructions

Copyright Protection

This product incorporates copyright protection technology that is protected by U.S. patents and other intellectual property rights. Use of this copyright protection technology must be authorized by Macrovision, and is intended for home and other limited viewing uses only unless otherwise authorized by Macrovision. Reverse engineering or disassembly is prohibited.

IMPORTANT FOR LASER PRODUCTS

1. CLASS 1 LASER PRODUCT

2. DANGER: Visible laser radiation when open and interlock failed or defeated. Avoid direct exposure to beam.

3. CAUTION: Do not open the top cover. There are no user serviceable parts inside the unit. Leave all servicing to qualified service personnel.

Region code information

DVD players and discs are coded by region. If the region number described on the DVD disc does not correspond to the region number of this product, this product cannot play the disc. The region code of this unit is 4.

High-quality audio and video

Excellent sound: Dolby Decoder delivers great sound.

AV input: External Audio, Video input can be connected to most external AV sources.

AV Output: Analog audio output can be connected to external amplifier.

Advanced Playing Functions

Compatibility: Compatible DVD, CD and JPEG discs, etc.

On-Screen Display: You can choose English, French, Spanish, etc. for the On-Screen Display language.

Particular Performance: Multi-speed, fast forward, fast backward, slow playback and repeated playback.

Search by Time: Search for a certain track of a disk by selected time.

Last Memory Playback: Memorizes the stopped playback track and continues playing the disk from this spot when the power is kept to supplied. (Only available for DVD and CD disc).

Special Functions: Supports screen multi-angle viewing, zooming function and foul language filtering function.

Other Special Functions

High Resolution: MPEG-2 decoding format achieves more than 500 lines of horizontal resolution.

Power Adapter Switch: Automatically adapts to voltage requirements in U.S and other countries.

Accessories

Accessories List

ITEM	NAME	QTY
	Remote Control (with battery)	1
	Power Supply Cord with AC Adapter	1
	Rechargeable Battery Pack	1
	DC Adapter (Car Adapter)	1
	Audio/Video Cable	1
	Headphone	1
	Carrying Case	1
	Operation Manual	1

NOTE:

Accessories and their parts numbers are subject to change without prior notice.

Important Safety Instructions1
Features4
Accessories5
View of Front Panel7
View of Side Panels9
View of Bottom Panel10
Using of USB and SD Card11
Remote Control12
System Connections15
Power Supply Preparation17
Rechargeable Battery18
Notes on Discs21
Playback Operation22
DVD Playback23
CD Playback26
JPEG Playback27
System Setup30
Carrying Case36
Definition39
Troubleshooting40
Specifications42

View of Front Panel



1. **LCD screen**
2. **Speaker**
3. **OUTPUT/INPUT Button**
Press to play disc or output AV signal or input external Audio/Video signal.
4. **TITLE Button**
Press to display title menu if it exists in the disc.
5. **Source button**
Press the SOURCE button to switch among disc playback, USB playback and the SD Card playback.

6. **SETUP Button**
Press to access or exit the system setup menu.
7. **MENU Button**
Press to access the DVD disc menu during playback.
8. **LCD MODE button**
Press to enter the brightness, contrast or color adjusting mode.
Press and hold for several seconds to change the aspect ratio among 16:9,4:3.
9. **|| Button**
|| : Press to pause the playback.
10. **■ Button**
■ : Press to stop playback. Then press the ▶(PLAY) button to resume playback from the stopped spot. Press this button twice to stop playback completely.
11. **▶ button**
▶ : Press to confirm selection.
12. **▲/ZOOM /+ Button**
▲ : Press to select different items.
ZOOM: Press to realize various zoom functions
+ : Press the Mode button and then press this button to increase the level of brightness, contrast and color.
13. **◀ /⏮/⏪ Button**
◀ : Press to select different items.
⏮ : Press to search backward fast.
⏪ : Press and hold it for several seconds to the previous list/track/chapter.
14. **▶ /⏭/⏩ Button**
▶ : Press to select different items.
⏭ : Press to search forward fast.
⏩ : Press and hold it for several seconds to go to next list/track/chapter.
15. **ENT/ ▶ (PLAY) button**
ENT: Press to confirm selection.
▶ (PLAY): Press to start playback.
16. **▼/SLOW/- Button**
▼ : Press to select different items.
SLOW: Press to activate slow playback function.
- : Press the Mode button and then press this button to decrease the level of brightness, contrast and color.
17. **Charge Indicator**
Light is red when the battery is being charged; green when it is fully charged.
18. **Remote Sensor**
19. **SD/MS/MMC card slot.**
20. **OPEN/PUSH button**
Press to open the disc tray cover.
21. **Disc tray cover**
When the disc is loaded gently press the cover to close it.

View of Side Panels

Right Side View

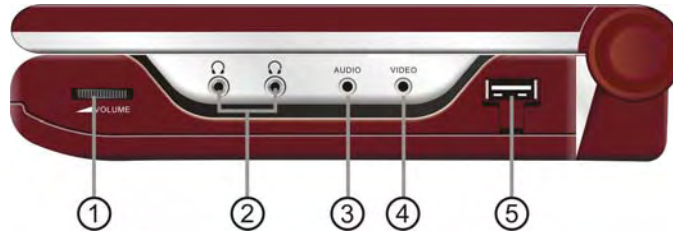

- 1. Volume Control knob**
Used to adjust the volume of the headphone and speaker.
- 2. Headphone Jack**
Used to connect to headphones for private listening. When headphone is plugged, the speakers will turn off automatically.
- 3. Audio Input/Output Jack**
For connecting to an external amplifier or audio source.
- 4. Video Input/Output Jack**
For connecting to an external monitor or video source.
- 5. USB slot.**
For connecting to USB.

Left Side View



- 1. DC 9.5/12V Input Jack**
Used to connect the DC 9.5/12V adaptor.
- 2. Power ON/OFF Switch**
Switch the power on or off.

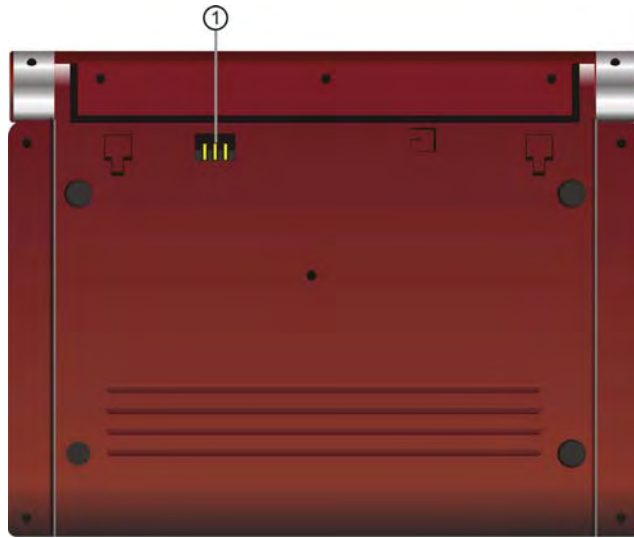

- 1. Rechargeable Battery Contacts**
For connecting the rechargeable battery pack.

Using of USB and SD Card

1. Connect the unit with the electrical power.
2. Switch the power to ON.
3. insert the USB into the unit's USB slot, or insert the SD card into the SD card slot
Please see the below figure:
4. Push SOURCE button on the front panel to switch among disc playback, USB playback and the SD Card playback.



- Make sure that files of JPEG or WMA format are stored in the USB and the SD card before the connection.
- Press the SOURCE button to switch among disc playback, USB playback and the SD Card playback. The default state is disk playback. Please see the below figure:

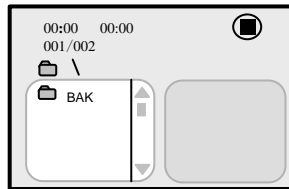

- Press the ▲, ▼ button to select the folder, and press ENTER/ENT button to enter.
- Press ▲ and ▼ buttons to select the desired track. Then press PLAY or ENT to start playback.
- Press STOP/■ button to stop playback: if the STOP/■ button is pressed, the playback will start from the beginning of the current track. Press the ◀ button to return to the folder menu.

Pull out the USB or SD card directly after the JPEG or WMA format files are played. Then the unit will be in the state of disc playback again.

NOTE: the USB slot can not be used for digital camera with USB function or connected with other devices.

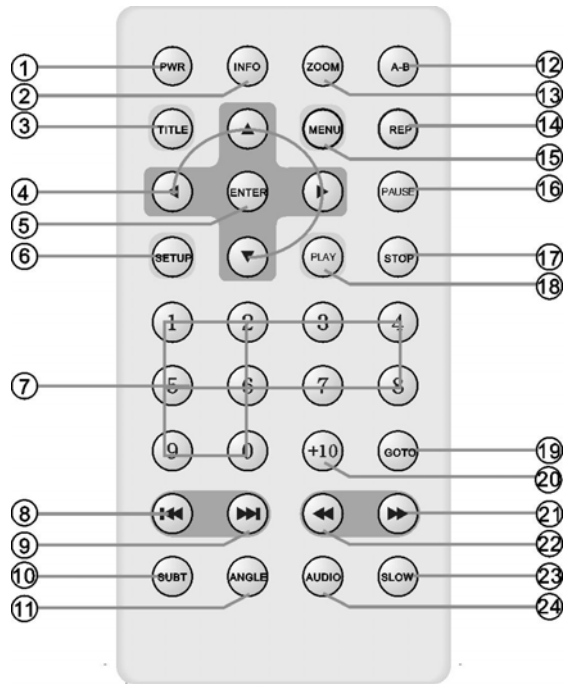

1. **PWR button**
Press to turn unit on or off
2. **INFO button**
Press for detailed information on the disc. Press the button again to remove information from screen.
3. **TITLE button**
Press to display title menu if the titles are coded in the disc.
4. **Direction button**
Press to select menu items.
5. **ENTER button**
Press to confirm your selection.
6. **SETUP button**
Press to access the DVD player's setup menu.

Remote Control

7. **0-9 number buttons**
Select numbers by pressing these buttons.
8. **◀ button**
Press to return to the previous list, track or chapter.
9. **▶ button**
Press to go to the next track or chapter.
10. **SUBT button**
When playing a DVD coded with multi-subtitles, press to select a subtitle language or to turn subtitles off.
11. **ANGLE button**
Press to access various camera angles, if the DVD disc contains multiple camera angles.
12. **A-B button**
Press to play a section of the disc from point A to point B. Press once to select the starting point (A), press again to select the end point (B). In A-B repeat playback, press this button to stop the repeat.
13. **ZOOM button**
Press to enter and cycle through zoom functions, use the direction buttons (◀ ▶ ▲ ▼) to move around the screen.
14. **REP button**
Press to repeat a chapter, track, title, or the entire disc.
15. **MENU button**
Display the actual DVD Disc Menu on screen in playback mode.
16. **PAUSE button**
Press to pause playback. Press the PLAY button to resume normal playback.
17. **STOP button**
Press once to stop playback. Press the PLAY button to resume normal playback. Press the button twice to stop playback completely.
18. **PLAY button**
Press to start playback.
19. **GOTO button**
Press to select the desired disc starting time, track or title.
20. **+10 button**
Select number greater than 9 by pressing the (+10) button first, and then additional number button as needed.
21. **▶▶ button**
Press to fast search forward during playback.
22. **◀◀ button**
Press to fast search backward during playback.
23. **SLOW button**
Press to activate slow playback.
24. **AUDIO button**
Press to access various audio languages, when the DVD disc contains multiple audio languages.

Preparation of Remote Control

Follow the steps below to install the battery.

1. Pull the battery holder out from the remote control in the direction of the arrow.
2. Load a new battery properly with the (+) sided up.
3. Insert the battery holder back into the remote control.

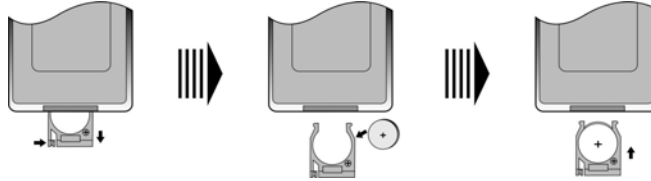

Battery type: CR2025 3V

Battery service life: approximately 1 year under normal use (at room temperature).

Use of Remote Control

Point the remote control unit to the remote sensor within the range of 16 feet and angles of 60 degree, and without obstacles between remote control and remote sensor.

Note

- Improper use of the battery may cause overheating, explosion or ignition, which can result in an injury or a fire. Battery leakage may damage the remote control.
- Do not expose the remote control unit to direct sunlight.
- Do not recharge, disassemble, deform or heat the battery.
- Do not put the battery in fire or water.
- Immediately replace the exhausted battery.
- Take out battery when the remote is not in use for a long time.



System Connections

- Always ensure that the DVD player, TV and any other electrical equipment to be connected with are switched off and unplugged from the power supply.
- Ensure that you observe the color coding when connecting audio and video cables.

Connecting to TV

Follow the drawing below to connect the DVD player to TV's Audio/Video input with Audio/Video cable.



Connecting to An Amplifier

Refer to your audio equipment's manual before connection.
Follow the drawing below to connect the DVD player to AV amplifier.



Connecting to External AV Source

The player supports an AV signal input function. Use the audio/video cable to connect the unit to an external AV signal source such as a DVD, VCR etc. After connecting, press the OUTPUT/INPUT button to enter AV Input statement.

NOTE: Noise may occur in speakers when there is an external audio signal input while playing a DVD disc. Unplug the audio cord to clear the noise.

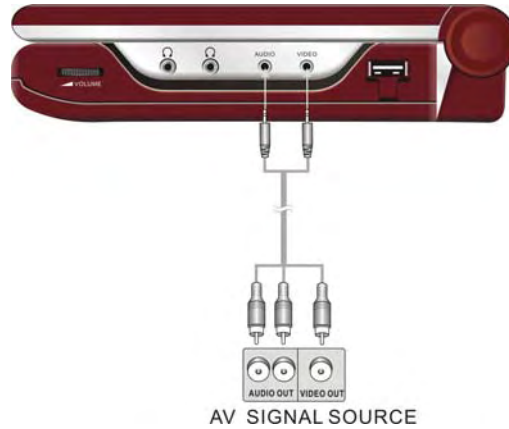

Connecting to the Headphones

Connect the headphones to the headphone jack on either side of the player.



When headphone is connected, the speakers will automatically turn off.

Power Supply Preparation

Using the AC Adapter

The player is supplied with an AC adapter for powering the unit and charging the battery.

1. Connect AC adapter to the left side of the DVD player in the jack marked DC 9.5/12V IN as shown on the right.
2. Plug the two-prong end of the power cord into a grounded electrical outlet. The power indicator lights red.



- Note:**
1. Turn player's power off before unplugging.
 2. In the case of using the adapter, the LCD screen will be brighter than using the rechargeable battery.

Using of Car Adapter

The player is supplied with a Car Adapter for powering the unit and charging the battery in a vehicle.

Connect the car adapter power plug to the unit's power jack and the other end to the vehicle's 12V accessory/cigarette lighter socket as the right figure.

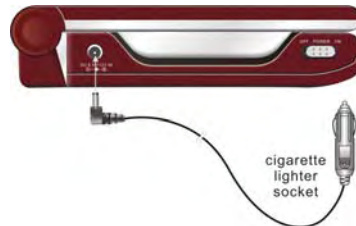

Attention

- Do not operate the unit or view video software while driving a vehicle.
- Place the unit in a proper position for viewing.
- Detach battery pack when using the AC or car adapter as power source.
- Disconnect the player from the Car Adapter when starting the vehicle.

About Rechargeable Battery Pack

Your portable DVD player comes with a lithium ion rechargeable battery that attaches to the bottom of the DVD player. Charge the battery fully before initial use. Charging time is normally about 5 hours. A fully charged battery delivers about 3 hours of use but playing time varies from disc to disc. If the battery will not be used for a long period of time, charge the battery fully before storage.

Working conditions and precautions for the rechargeable battery

- New battery should be fully charged before initial use.
- Battery should only be used and charged when temperature is between 32-100F.
- Never put the battery in fire or water.
- Do not expose the battery to high temperature or store in hot, sunny place.
- Maintain well-ventilated conditions around the product to avoid overheating. Don't put the product on a bed, sofa or anything that may block ventilation to the product.
- Do not short the battery terminals.
- Do not open the battery.
- Detach the battery after charging is complete. When charging the battery pack, the charge light will turn red, when the charging is complete, the light will turn green.
- Detach the battery when it is not in use.
- When the charge of the battery is weak, low power indicator will appear on the LCD screen. The player will turn off automatically about several minutes later.

Warning:

Do not touch any metal object to the battery connectors, as it will put the battery in standby mode. To exit the standby mode, connect the battery and DVD player to AC or DC power.

Rechargeable Battery

Attaching the Battery Pack

Refer to the following steps for attaching the Battery Pack:

1. With one hand on the DVD Player to prevent it from moving, take the battery and align the plastic tabs on the battery pack with holes on the player, and push the battery pack into the DVD Player.
2. Slide the Battery Pack until you hear it click and lock into place.

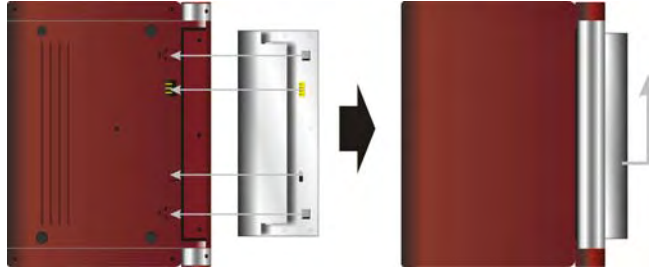

Charging the Battery Pack

The battery pack must be attached to the DVD player to charge it by using the supplied AC Power Adapter.

1. Attach the battery pack to the DVD player.
2. Plug the supplied AC Power Adapter into the player's power jack marked with "DC 9.5/12V IN", which is located on right side of the DVD Player.
3. Plug the other end of the AC Power Adapter Cord into a household AC Outlet as shown below:



Rechargeable Battery

Detaching the Battery Pack

When being turned off, the DVD Player still consumes some power in standby mode. This will eventually discharge the battery. If the DVD Player is not going to be used for long periods of time, the battery pack should be detached.

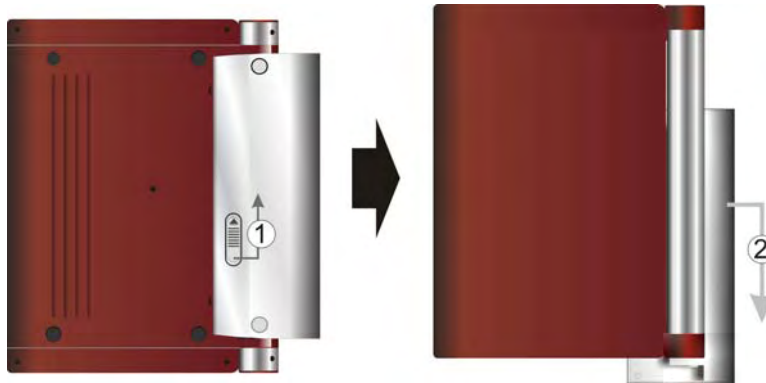

Make sure the power is turned off before detaching the Battery Pack.

1. Press and hold the Battery Release Tab in the direction of the arrow ① as shown in Fig.1 below.
2. Slide the Battery Pack gently towards the direction of the arrow ② as shown in Fig.1 below.
3. Carefully remove the Battery Pack from your player.



Notes on Discs

Compatible Disc Formats

	DISC LOGO	DIAMETER	PLAYBACK TIME/ PLAYABLE SIDES
DVD		12cm	133 min (SS-SL)
			242 min (SS-DL)
			266 min (DS-SL)
			484 min (DS-DL)
		8cm	41 min (SS-SL)
			75 min (SS-DL)
82 min (DS-SL)			
CD		12cm	74 min
		8cm	20 min
JPEG		12cm	

Operation methods of some DVD discs are specified by the software manufacturer. Please follow the instructions of the disc.

Care of Discs

Holding Discs

When loading or removing discs, try not to touch their playing surfaces as the right figure.



Cleaning

Fingerprints or stain on the disc may affect the quality of sound and picture. To clean your discs, use a soft clean cloth to wipe them. If necessary, moisten a soft cloth with diluted neutral detergent to remove heavy dirt or fingerprints.



Do not wipe in a circular direction as the figure in the right middle (concentric scratches on the disc groove tend to cause noise). Gently wipe from the center of the disc to the outer edge as the right figure.



Playback Operation

PLEASE READ THE FOLLOWING INSTRUCTIONS CAREFULLY BEFORE USING YOUR DVD PLAYER FOR THE FIRST TIME.

WARNING: Do not play poor quality discs to avoid damaging the lens.

Pre-operation

1. Connect the unit to power supply through the provided AC adaptor.
2. Switch "POWER ON/OFF" to "ON" to turn on the DVD player.
3. Push the OPEN switch on the unit to open the disc tray cover. Put a disc in the disc tray with printed side up. Close the disc cover. (See below)



4. The player will search disc and play it automatically.
5. Adjust the volume with the VOLUME control on the right panel to the desired level.
6. To turn the player off, switch the POWER ON/OFF on the left panel to OFF.

Basic Operation

LCD MODE button →

Press the MODE button and then press the + button or - button to adjust brightness, contrast and color of the screen.
Press the MODE button and hold it for several seconds to change the aspect ratio among 16:9,4:3 .

Normal WIDE 16:9 Normal LB/4:3 Normal WIDE 16:9

ZOOM button →

For DVD disc, press the ZOOM button to display the image as 2x-3x-4x-1/2-1/3-1/4-normal size in sequence.
For JPEG disc, press ZOOM button first, then press the ► button to enlarge the picture as follows: 125%-150%-200%-normal size ; press the ◀ button to reduce the picture as follows:75%-50%-normal size.
This function is not available for CD disc.

Playback Operation

DVD Playback

ENTER/ENT button



Load a disc in, the player will search the disc and play it automatically. Press the direction buttons (◀ ▶ ▲ ▼) to highlight the item that you want to play and press the ENTER/ENT button to confirm.

PAUSE/II button



Press the PAUSE/II button to pause during playback and press the PLAY/▶ (PLAY) button to resume normal playback.

STOP/■ button



During playback, press the STOP/■ button once to stop playback and then press the PLAY/▶ (PLAY) button to resume normal playback from the place where the STOP/■ button is pressed. Press the STOP/■ button twice repeatedly to stop playback completely.

MENU button



Press the MENU button during playback. The root menu will appear on the screen. Press the direction buttons (◀ ▶ ▲ ▼) to select the item you wish to play, and press the ENTER/ENT button to confirm. Or press the 0-9 and +10 buttons to select the item you prefer directly.

TITLE button



In general, the content of a DVD disc can be divided into several titles, and also there are several menus in a title. Press the TITLE button during playback. The title menu will appear on the screen. Press the direction buttons (◀ ▶ ▲ ▼) to select the title or disc menu item you want to watch and then press the ENTER/ENT button to confirm. Or press the 0-9 and +10 buttons to select the item you prefer directly.

⏮️⏭️ buttons



Press the ⏮️ button to go to the previous chapter. Press the ⏭️ button to play the next chapter.

DVD Playback (continued)

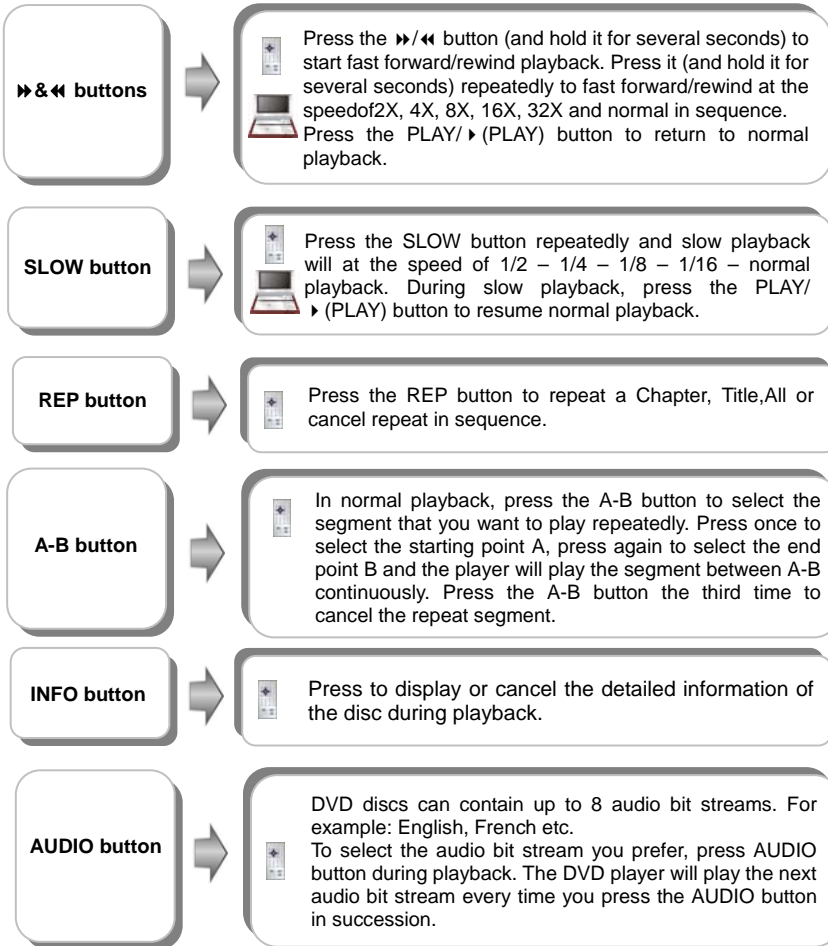

Playback Operation

DVD Playback (continued)

SUBT button



When a DVD is playing, press the SUBT button to select a subtitle language or to turn subtitle off. A DVD disc can be recorded with at most 32 subtitles.

NOTE: This function is available for discs recorded with multi-subtitles

ANGLE button



Press the ANGLE button to play the disc in multi-angle. Multi-angle means that a scene is shot from different angle so that audience can watch from any angle, like the drawings below:

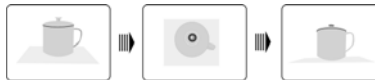

If there are multiple angles in a scene, you can use the ANGLE button to select the angle you like to enjoy. Press the ANGLE button repeatedly to view different angle.
NOTE: This function is only available for the DVD disc that coded with multi-angle.

GOTO button



Press the GOTO button to select desired disc starting time, track or title.



- Press the ▲ ▼ buttons to move the yellow light bar to the item you prefer, then press the ENTER button (or ENT button on the front panel) to confirm
- The corresponding item is highlighted (just for Title, Chapter, Angle, Tt Time <Total Time>, Ch Time <Chapter Time>), use 0-9 buttons to select directly according to your preference.
 - The sub-menu of the selected item is displayed (just for Audio, Subtitle, Repeat, Time Disp.<Time Display>), use the ▲ ▼ buttons to move the yellow light bar to the item you prefer, then press the ENTER button (or ENT button on the front panel) to confirm.

CD Playback

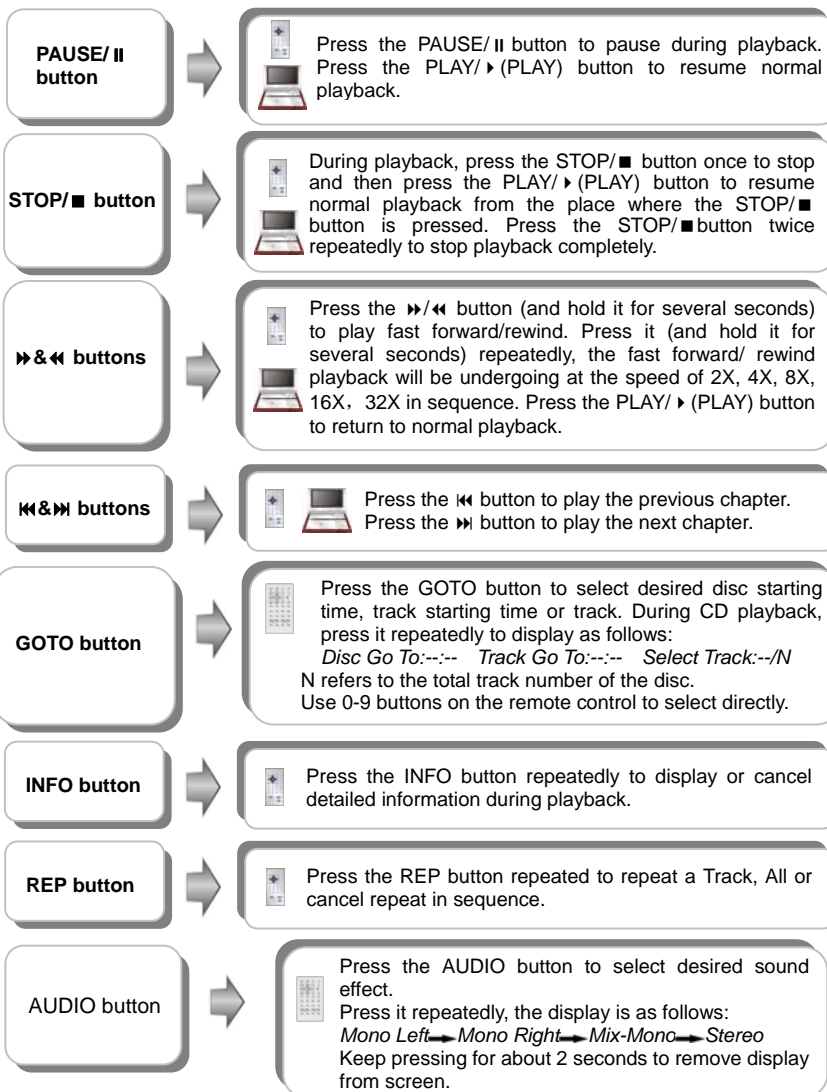

Playback Operation

JPEG Playback

Pre-operation

1. Load a JPEG in the disc tray, and the player will search and play disc automatically.
2. The screen displays the root folder with several subdirectories/subfolders. Use the **▲, ▼** buttons to select desired folder. Then press the **ENTER/ENT** or **▶ (PLAY)** button to confirm your selection.
3. The screen enters the selected subfolder with several files. Use the **▲, ▼** buttons to select desired file. Then press the **ENTER/ENT** or **▶ (PLAY)** button to confirm your selection.
4. Press the **◀** button to return to previous folder or directory.

Note: Many discs have other items besides pictures.

Buttons Operation

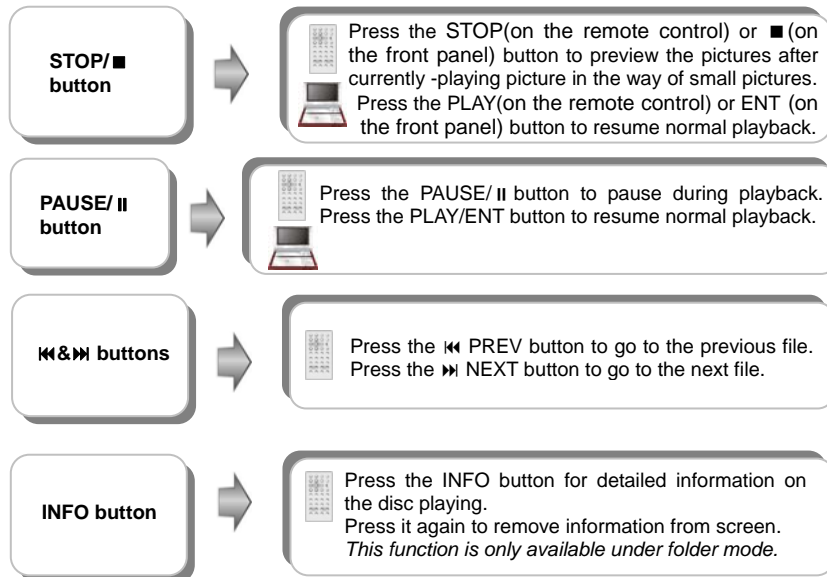

Playback Operation

Picture CD Playback (continued)

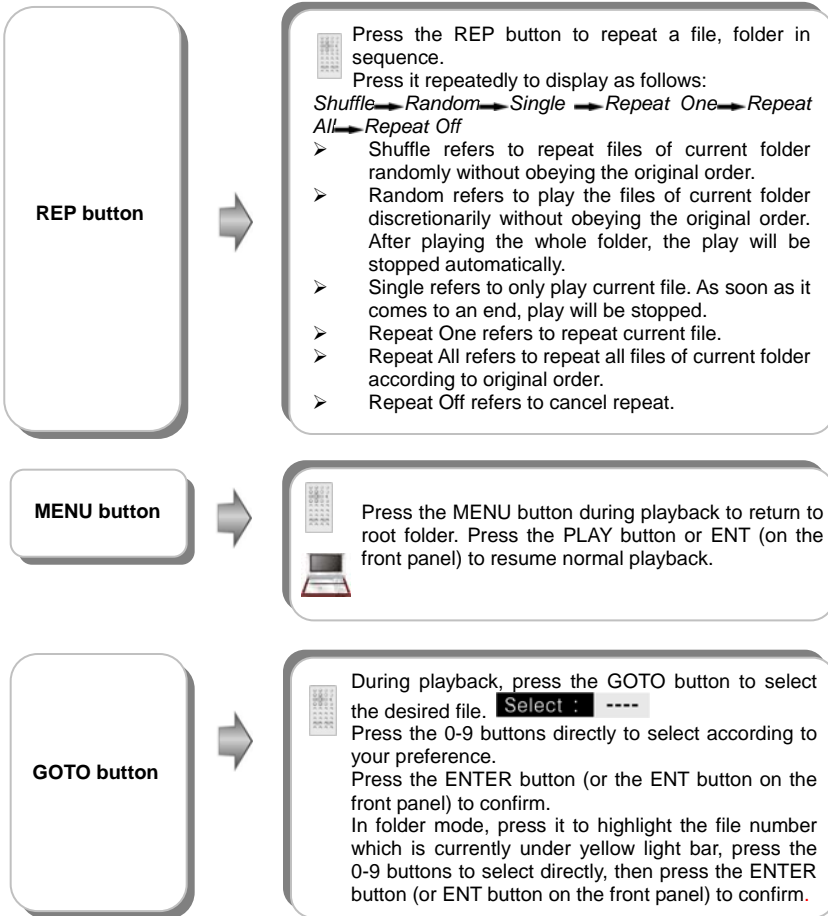



Playback Operation

Picture CD Playback (continued)

Picture Rotate

 During browsing a picture, you can press direction buttons ▲, ▼, ►, ◀ to rotate the current picture.

 Press the ► button to rotate the current picture clockwise, as following drawings:



Press the ◀ button to rotate the current picture anti-clockwise, as following drawings:



Note: Some picture CD discs are restricted by their designing method, and so have no rotating, zooming etc. function.

System Setup

You can change the default settings of this unit to customize its performance to your own preference. Read this section to learn how to set up the system.

Note: the system should better be set up in the state that no disc is in the DVD drive or the unit is on the stop mode.

Follow the steps below to set up your system:

1. Press the SETUP button on the remote control or the front panel.
2. The setup menu will appear on the screen. It includes General Setup Page, Speaker setup page, Dolby digital setup, Video setup page, Preference page and TVG Setup Page. You can exit the setup menu by pressing the SETUP button again at any time during setting.
3. Press the ◀ or ▶ (direction buttons) on the remote control or on the front panel to select a sub-menu that you want to set up.
4. Press the ▲ or ▼ button on the remote control or on the front panel to select the item that you want to set up in the sub-menu.

General Setup Page

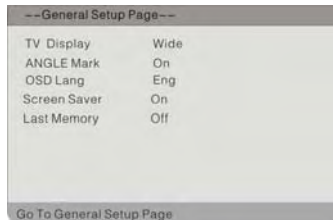

The items included in this sub-menu are shown as the left.

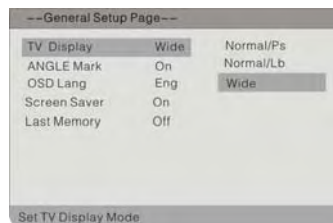

1.TV Display

This item is used to set TV display mode. Press the ▲ or ▼ button to highlight this item. Press the ENTER or ▶ button to enter the item. It includes Normal/PS, Normal/LB and Wide, Wide by default. Press the ▲ or ▼ button to choose the proper one. Press the ENTER button to confirm your selection. Press the ◀ direction button to exit from this item.
Note: Select Normal/PS or Normal/LB when a 4:3 TV is connected.
Select Wide when a 16:9 wide screen TV is connected.

System Setup

General Setup Page

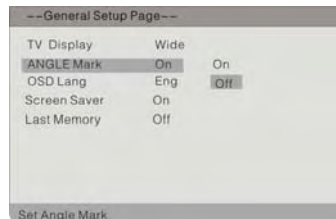

2.Angle Mark

This item is used to turn the Angle Mark on or off. Press the ▲ or ▼ button to highlight this item. Press the ENTER or ► to enter the item. Press the ▲ or ▼ button to choose angle mark on or off. Press the ENTER button to confirm your selection. Press the ◀ direction to exit this item.

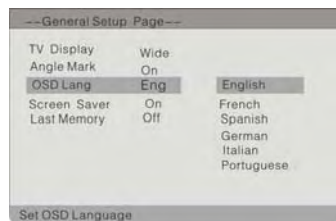

3.OSD Language

This item is used to set the OSD (on-screen display) language. Press the ▲ or ▼ button to highlight this item. Press the ENTER or ► to enter the setup of this item.

It includes English, French, Spanish, German Italian, and Portuguese. English by Default.

Press the ▲ or ▼ button to choose the proper one. Press the ENTER button to confirm your selection. Press the ◀ direction button to exit this item.

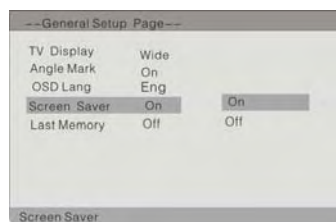

4.Screen Saver

This item is used to turn the screen saver on or off. Press the ▲ or ▼ button to highlight this item.

Press the ENTER or ► to enter the setup of this item. The default setting of this item is on.

Press the ▲ or ▼ button to choose on or off. Press the ENTER button to confirm your selection. Press the ◀ direction button to exit this item.

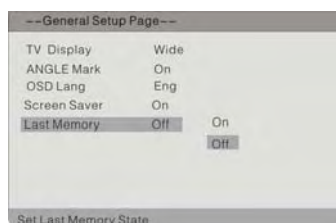

5. Last Memory

This item is used to set last memory state.

Note: The last memory refers to resume playback from the point that you stopped last time.

Press the ▲ or ▼ button to highlight this item. Press the ENTER or ► to enter the item.

The default setting of this item is off.

Press the ▲ or ▼ button to choose on or off. Press the ENTER button to confirm your selection. Press the ◀ direction button to exit this item.

System Setup

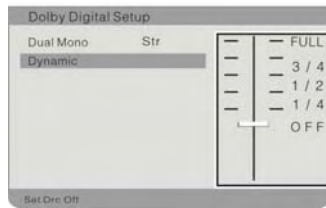

2.Dynamic

This item is used to adjust linear dynamic compression rate to get different signal compression Effects.

Press the ▲ or ▼ button to highlight this item.

Press the ENTER or ► to enter the setup of this item. Then the item will show as the left.

Press the ▲ or ▼ to choose the proper level.

Press the ENTER button to confirm your selection.

Press the ◀ direction button to exit this item.

Video Setup Page



The items included in this sub-menu are shown as the left.



1.Sharpness

This item is used to adjust the sharpness of the Screen.

Press the ▲ or ▼ button to highlight this item.

Press the ENTER or ► to enter the item.

It included High, Medium and Low, Low by default.

Press ▲ or ▼ button to choose the proper one.

Press ENTER button to confirm your selection.

Press ◀ direction button to exit this item.



2. Brightness

This item is used to adjust brightness level of the Screen.

Press the ▲ or ▼ button to highlight this item.

Press the ENTER or ► to enter the item.

Press the ◀ or ► button to adjust to desired level.

The default level is 00.

Press the ENTER button to confirm your selection.

System Setup



3. Contrast

This item is used to adjust contrast level of the Screen.

Press the ▲ or ▼ button to highlight this item.

Press the ENTER or ► button to enter the item.

Press the ◀ or ▶ button to adjust to desired level.

The default level is 00.

Press the ENTER button to confirm your selection.

Preference Page

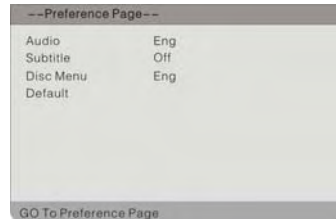

The items included in this sub-menu are Shown as the left.

Note: This sub-title can only appear in the state that no disc is in the DVD drive.

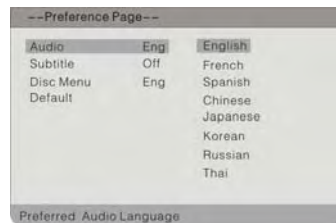

1. Audio

This item is used to set the audio output language.

Press ▲ or ▼ button to highlight this item.

Press the ENTER or ► button to enter the item.

The available languages are English, French, Spanish, Chinese, Japanese, Korean, Russian and Thai, English by default.

Press the ▲ or ▼ button to choose the preferred Language.

Press the ENTER button to confirm your selection.

Press the ◀ button to exit this item.

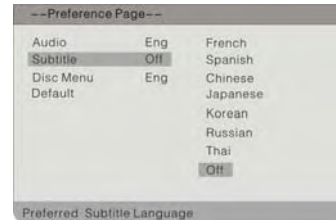

2. Subtitle

This item is used to set the subtitle language.

Press the ▲ or ▼ button to highlight this item.

Press the ENTER or ► button to enter the item.

The available languages are English, French, Spanish, Chinese, Japanese, Korean, Russian and Thai, Off by default.

Press the ▲ or ▼ button to choose the preferred Language.

Press the ENTER button to confirm your selection.

Press the ◀ direction button to exit this item.

System Setup

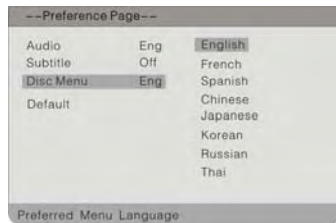

3. Disc Menu

This item is used to set the language of disc menu. Press the ▲ or ▼ button to highlight this item. Press the ENTER or ► button to enter the item. The available languages are English, French, Spanish, Chinese, Japanese, Korean, Russian and Thai, English by default. Press the ▲ or ▼ button to choose the preferred Language. Press the ENTER button to confirm your selection. Press the ◀ direction button to exit this item.

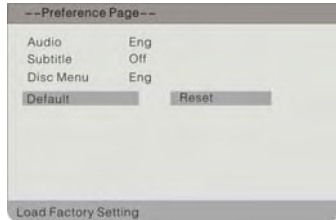

4. Default

This item is used to reset the unit. Press the ▲ or ▼ button to highlight this item. Press the ENTER or ► button to enter this item. Press the ENTER button to reset. Then all the settings of your unit will return to the Original status.

TVG Setup Page

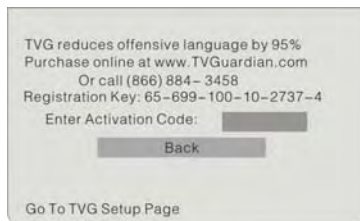

TVG--Activation

This item is used to filter foul language in the disc during playback. Obtain your activation code via the appointed web or the phone number. Press the ▲ button to highlight code column. Use the 0-9 number buttons to enter the code. Press the ENTER/ENT button to activate this function.

INSTRUCTIONS FOR ATTACHING YOUR PORTABLE DVD PLAYER CASE IN A VEHICLE

Please read and follow these instructions carefully when attaching this case inside your vehicle. For ease of installation, do not place the DVD player into the case until after the case is attached inside the vehicle.

Caution

1. Do not use this DVD Player Case as a swing, car seat, or for any other purpose except to hold a DVD player and accessories.
2. The DVD Player Case is intended for viewing only from the rear seats. Do not install or use this product in the front seat of a vehicle.
3. To reduce the chance of injury in case of collision or a sudden stop:
Always keep the DVD player strapped securely inside its case while the vehicle is moving.

Always keep the DVD player Case securely attached inside the vehicle while the vehicle is moving.

Your DVD player can be securely attached in one of the following ways to view movies from the rear seats:

1. Directly behind either the driver or the passenger seat.
2. Between two front bucket seats.

CAUTION

Always position the plastic hooks and strap adjustment slider so that they do not contact the back of the head of the person in the front seat.

Carrying Case

To attach the DVD Player Case to a seat back (Photos 1 & 2):

1. Unzip the main compartment that holds the player; locate the set of rings tucked inside the top edge of the case (A).
2. Locate the 2 straps with hooks on each end.
3. Hook one end of each strap to the rings at the top of the case (A).
4. Criss-cross the straps around the front of the headrest (B) and hook the straps to a second set of rings on the lower part of the case (C).
5. Tighten up the straps until secured.

Photo 1



Photo 2



To suspend the DVD Player Case between 2 bucket seats (Photo 3):

1. Unzip the main compartment that holds the player; locate the set of rings tucked inside the top edge of the case (A).
2. Locate the 2 straps with hooks on each end.
3. Hook one end of each strap to the rings at the top of the case (A).
4. Wrap each strap around the headrest or seat; hook the straps to a second set of rings on the lower part of the case (C); in some vehicles, the middle rings in the gusset might work best (D).
5. Tighten up the straps until secured.

Photo 3



Definition

Letterbox screen

This refers to a screen on which the playback picture of wide-screen DVDs appears with black bands running along the top and bottom.

Pan & Scan screen

This refers to a screen on which the playback picture of wide-screen DVDs is cut off at the left and right sides.

Title, Chapter (DVD)

DVDs are divided into some large sections (titles) or some small sections (chapters). Each section is numbered: these numbers are called Title number or Chapter number.

Title 1	Title 2
Chapter1	Chapter 1
Chapter2	
.....

Track (CD)

CDs are divided into some sections (tracks). Each section is numbered; these numbers are called Track number.

Track 1	Track 2	Track 3
---------	---------	---------	-------

JPEG

JPEG is a common picture format that has small file size and low quality loss rate of picture. Hundreds of pictures can be stored in a disc in this format. In order to utilize real digital album, use film to make a Picture CD in JPEG format.

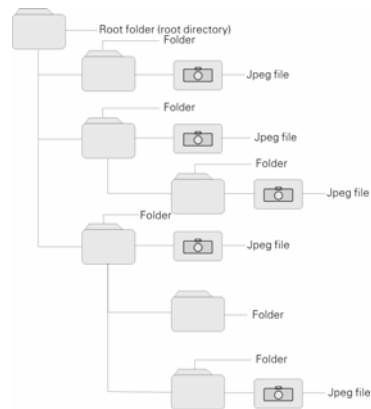

Troubleshooting

If you suspect there is something wrong with the DVD player, immediately turn the power off. Disconnect the power connector and check that there is no smoke or excessive heat coming from the unit.

Never open or try to repair the unit yourself. There are no user serviceable parts inside.

PROBLEM	POSSIBLE CAUSE	POSSIBLE SOLUTION
The player cannot play.	The disc cover may not be closed.	Close the disc cover.
	There may be no discs in the DVD drive.	Put a disc in to the DVD drive.
	The disc may not be put in in the right way.	Put the disc in with the label side up.
	The disc may be dirty or warped.	Clean or change the disc.
	The player's region code may not be the same as the region code of DVD disc.	Make sure the player's region code is the same as the region code of DVD disc.
	There may be water on the lens.	Remove the disc and keep the player being powered off for at least two hours.
There is no sound .	The system connection may be not correct.	Connect the system correctly.
	The speakers may be turned down.	Turn on the speaker.
	The sound setup of the DVD disc may be not correct.	Setup the sound of the DVD correctly.
	The disc may be dirty or warped.	Clean or change the disc.

Troubleshooting

PROBLEM	POSSIBLE CAUSE	POSSIBLE SOLUTION
There is no picture.	The LCD may be not in correct video mode.	Choose the correct video mode.
	The system connection may be not correct.	Connect the system correctly.
	The unit may be not in AV out mode.	Switch AV IN/OUT on the right panel to OUT.
Poor AV performance.	The disc may be dirty or warped.	Clean or change the disc.
The remote control does not work	There may be some obstructions between the remote control and the player.	Remove the obstruction between the remote control and the player.
	The remote control may not be pointed at the player.	Point the remote control at the player directly.
	The batteries of remote control may not be inserted correctly.	Make sure the polarity of each battery is correct.
	The batteries of remote control may be out of power or weak.	Replace the batteries.

Other possibilities:

Static or other external interference may cause the player function abnormally. In order to recover normal status, please unplug the power-supply cord and then plug it into the outlet again to reset the player. If the problems still exist, please cut off the power supply and consult your service center or the qualified technician.

Specifications

TFT screen size	8 inches (16: 9)
Screen resolution	480x234
Laser Wavelength	780/650nm
Video System	NTSC
Frequency Response	20Hz-20kHz ± 2.5 dB
Audio Signal-to-noise Rate	≥ 85 dB
Audio distortion + noise	≤ -70 dB (1kHz)
Channel Separation	≥ 70 dB (1kHz)
Dynamic Range	≥ 80 dB (1kHz)
Audio Out	Out Level $2V_{\pm 0.2}$, Load $10k\Omega$
Video Out	Out Level $1V_{P-P \pm 0.2}$, Load 75Ω Unbalanced Negative
Power	AC100~240V (50Hz/60Hz)
Dimensions	205mm x 153mm x 41mm
Weight	Approximate 1.12 Kg

DESIGN AND SPECIFICATIONS ARE SUBJECT TO CHANGE WITHOUT NOTICE

Manufactured under license from Dolby Laboratories.
“Dolby” and the double-D symbol are trademarks of Dolby Laboratories.
Confidential unpublished works. © 1992 -1997 Dolby Laboratories, Inc.
All rights reserved.

For service, support and warranty information, visit www.polaroid.com
or in Mexico call 01-800-400-2443.

"Polaroid" and "Polaroid and Pixel" are trademarks of Polaroid Corporation, Waltham, MA, USA.